



Najad 355.
Challenge
yourself in
comfort.

Easy handling, surprisingly spacious and good sailing characteristics.

The Najad 355 – Sailing performance beyond what you might expect from a safe and comfortable cruising yacht.

Some facts:

The strong well-dimensioned hull is designed to offer first-class sailing without encroaching on interior space or Najad's state of the art safety.

- To give you a strong, stiff hull – where it's practically impossible for water to penetrate (osmosis) – Najad yachts are constructed entirely from vacuum-infused Vinylester resin technology
- Generous provision for stowage on deck: Ample cockpit and transom lockers will swallow large items. Lines led aft are contained in purpose made bins each side of the wheel, for a tidier and more comfortable cockpit area.
- The windscreen is another unique Najad feature, designed to give you great shelter from the wind allowing a more relaxed voyage. Hence, you will arrive to your destination well rested and in good mood.

Below deck:

- Down below symmetries and sight lines give a wonderful impression of how much space and volume there is
- Hand polished mahogany and dark wood joinery have been contrasted together to project warmth and quality in every cabin
- Standing headroom in nearly all areas
- Refined details such as leather covered grab rails, dimmer switches and self closing galley drawers

Designed by Najadvarvet, judel/vrolijk & co and Rhoades Young.

Specification:

Length overall	10.90 m
Length waterline	9.58 m
Beam	3.40 m
Draught	1.90 m
*Alternative, shallow draught	1.70 m
Displacement	6.9 t
Ballast	2.3 t
Mast height above water line	16.50 m
Engine Volvo Penta D1-30S (20.2 kW)	28 hp
Water capacity approx.	250 l
Fuel capacity approx.	150 l
Holding capacity approx.	60 l







Below Deck features:

- Light and surprisingly spacious
- Standing headroom in nearly all areas including kitchen/galley
- Hand polished mahogany and dark wood joinery
- Attention to details: leather covered grab rails, dimmer switches and self closing galley drawers

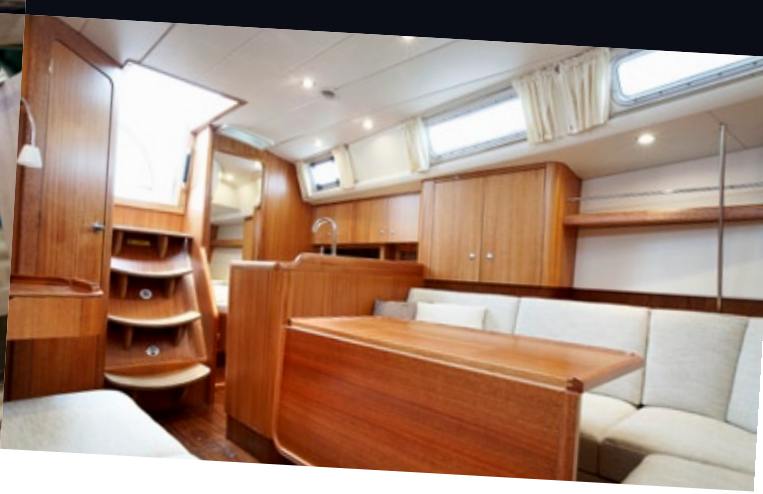

Spacious galley and headroom to cook, even in moderate gale.

On trademark of Najad interiors is the spacious fit below deck, of course always with maintained good sailing characteristics.

Since food is a major part of life we believe that the kitchen should be just that - a kitchen, not a galley. Therefore it is designed as equally suited to the long-term live-aboard and ocean adventurer, as to a gentler life of coastal cruising and island hopping.

Just as in a normal kitchen, the attention to details, good crafts, sturdiness and design is crucial. Only here it's multiplied by 20 for obvious reasons; the powers of the sea. So the design is based on the fact that you should be able to cook, even under moderate gale conditions.

One subtle, smart detail is self-closing drawers. No self-cooking food, though. So, you still have to do the cooking yourself, we're afraid.

The birth of your yacht. Follow it on site and from the palm of your hand.



Being a passionate sailor, you are invited to build your yacht together with our equally passionate craftsmen.

Just like you, our customers are genuine and passionate sailors who appreciate the good things in life. Mrs Bodil Hägg (relaxing in the picture on the right) is one of these committed customers. "I ordered my new yacht on a strength of drawings alone and was in love with the concept right from the start", she says. It gives us great pleasure to see that our own passion for shipbuilding and custom-made

solutions evokes such pleasant reactions. The re-known safety and seaworthiness of a Najad hull are things that keep these passionate sailors calm.

The fact that they can follow the work in progress on site, but also through updates on their Najad Ipad is also keeping them at ease.

You are a passionate sailor and we are equally enthusiastic shipbuilders committed to make your dream project come true in the best possible way. After all, it's your baby.



The unique Najad windscreen. Designed to give you great shelter enabling a more relaxed voyage. Hence, you will arrive well rested.

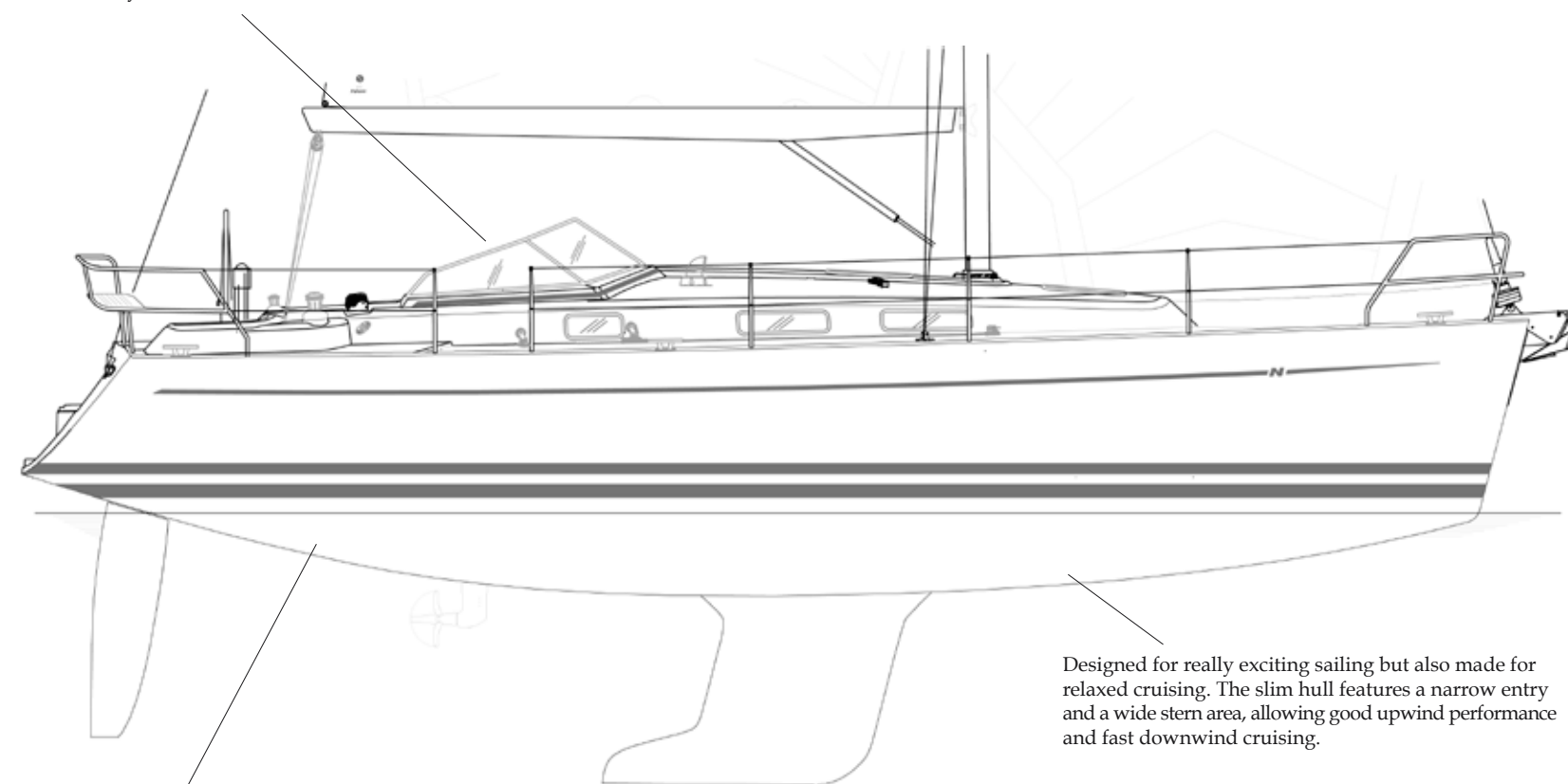

The self-sustaining hull is a unique Najad hallmark. Designed for utmost safety, the hull and deck are supported by an advanced system of bulkheads and stringers, meaning the hull does not need support from the interior. This solution also allows us the ability to design the interior around your needs.

Designed for really exciting sailing but also made for relaxed cruising. The slim hull features a narrow entry and a wide stern area, allowing good upwind performance and fast downwind cruising.

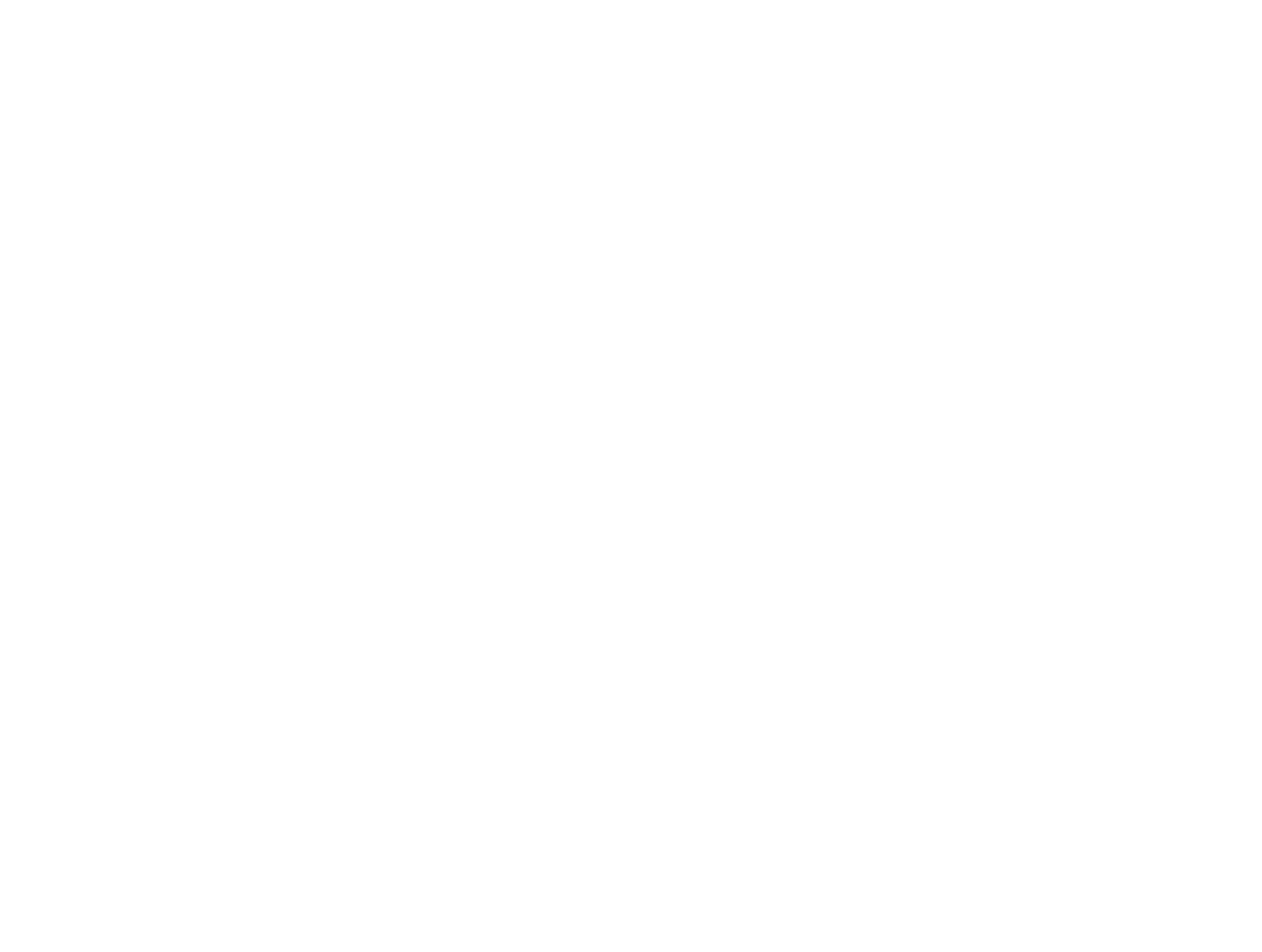



No two Najad
owners are alike.

Neither are their yachts.

Personalizing your dream project is a major part of the Najad concept. It already starts before you sit down at the drawing board. Our people will discuss in detail with you how and where you will use your yacht and what you expect from your Najad. Based on your wishes you will receive a fully detailed customized solution and offer.

Apart from changes to the hull form and main bulkhead positions, every new 355

can be customised to satisfy the needs and the preferred sailing style of each owner. The internal layout, accommodation and living arrangements can be individually specified and matched with different fabrics and colour schemes.

Consequently every new yacht becomes a personal statement – an expression of individuality and style linked with each owner's practical needs on board.

This interaction between customer and boat builder is an important dynamic. No Najad Yacht is like any other; each reflects the sailing life of their owners. Of course they all have the same strong all-weather hulls, that will take you anywhere on the seven seas, and they're all built with the same fastidious attention to detail. But each of them speaks volumes about the way its owner takes to the sea.

Optional cupboard

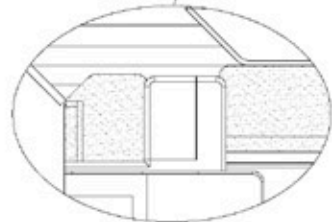
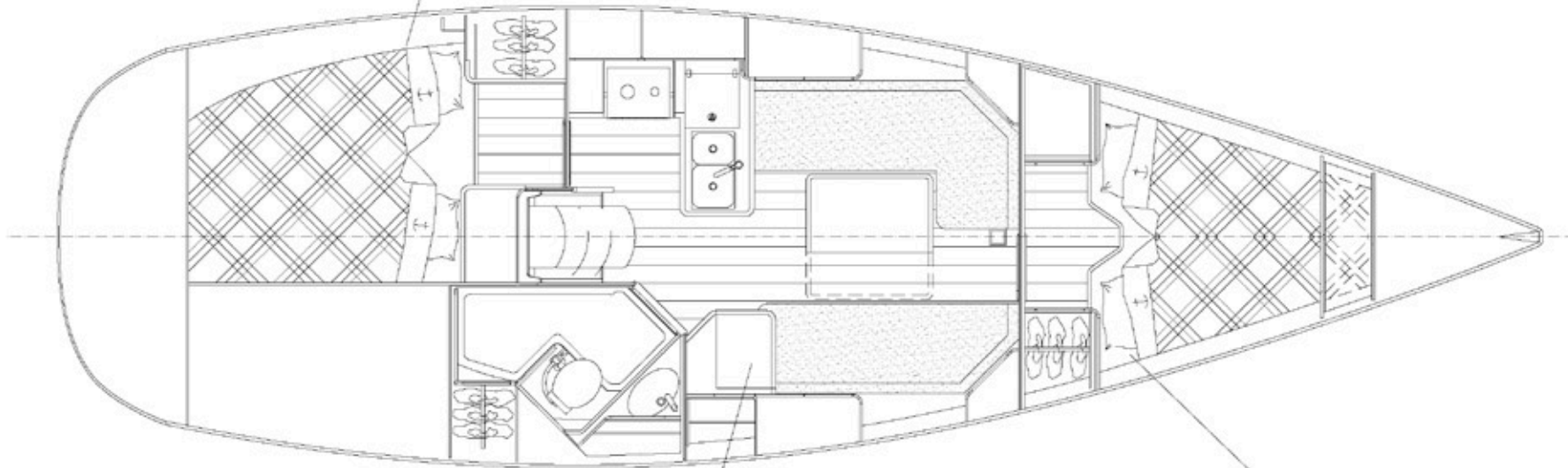
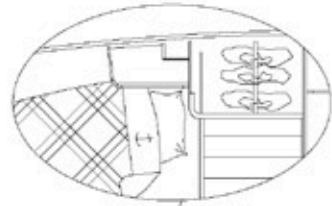

Optional navigation table

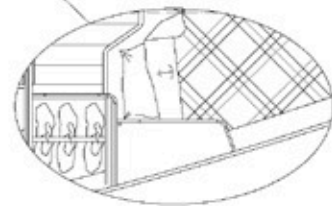

*Optional cupboards
Port and Starboard*

At Najad we have this thing for authenticity. Therefore we travel to African and Asian wood suppliers (we do not use wood from wild trees) to pick out only the best wood suited to become the deck and interior on your yacht.

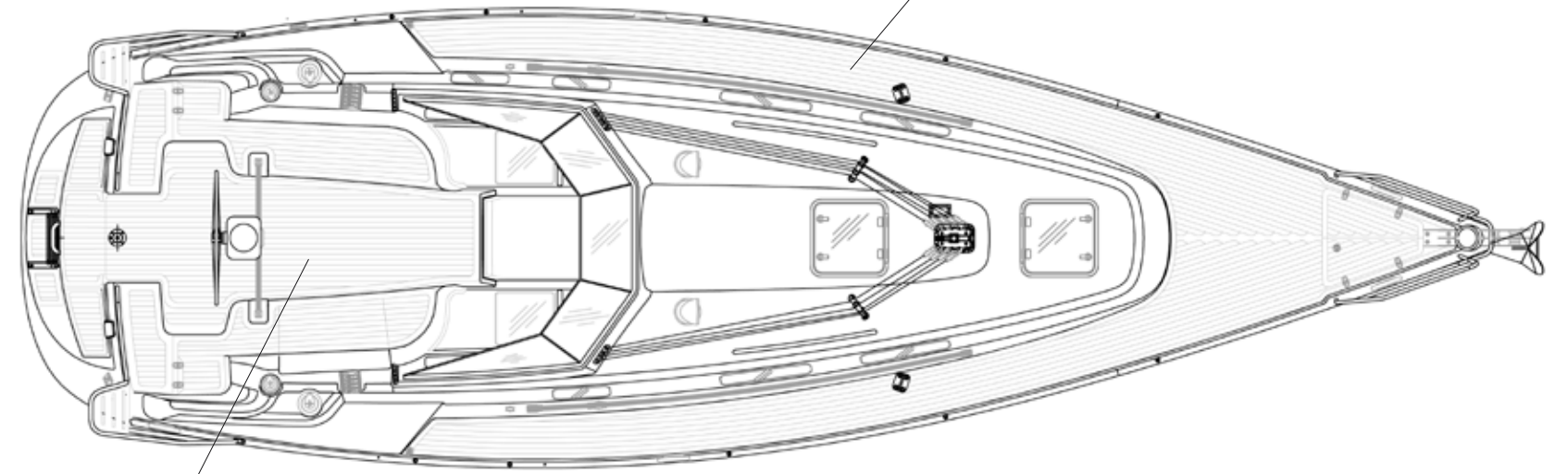

The Cockpit - perfect for sailing and socializing. Spacious, deep and safe cockpit for ease of handling and room to wine and dine in comfort.





Standard

FLEX Cruise in Polyester

Double-sided taffeta sails with a laminate in seven separate scrim layers in different directions. This creates a stronger sailcloth with the ability to absorb and share primary and secondary loadings more evenly.

The surface layer is made from woven polyester taffeta with great anti-wear and tear characteristics. This layer also has an anti-microbe coat minimizing the risk of mildew growth.

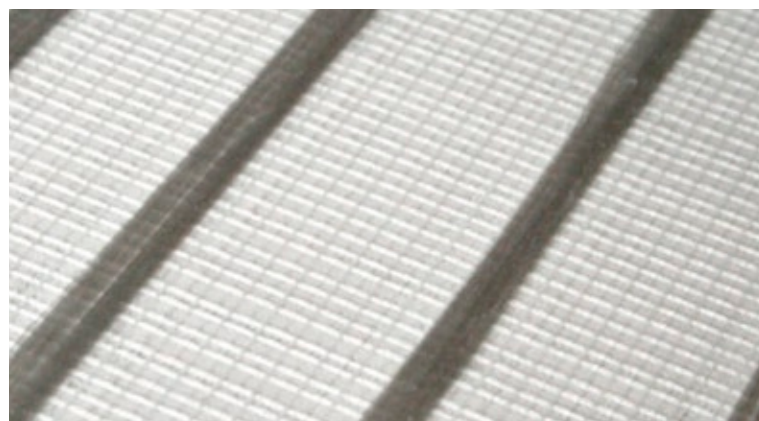

Option

Tape-Drive – Stronger, lighter, faster

The secret of Tape-Drive's strength is the web of low-stretch tapes that run along the sail's primary load paths from corner to corner. Because the major stresses in a sail are borne by tapes, the base sail cloth only needs to be a lightweight laminated skin fabric. Tape-Drive sails are light enough to lift and fill to get the 3 going in light breezes, while being strong enough to hold their shape in a blow.

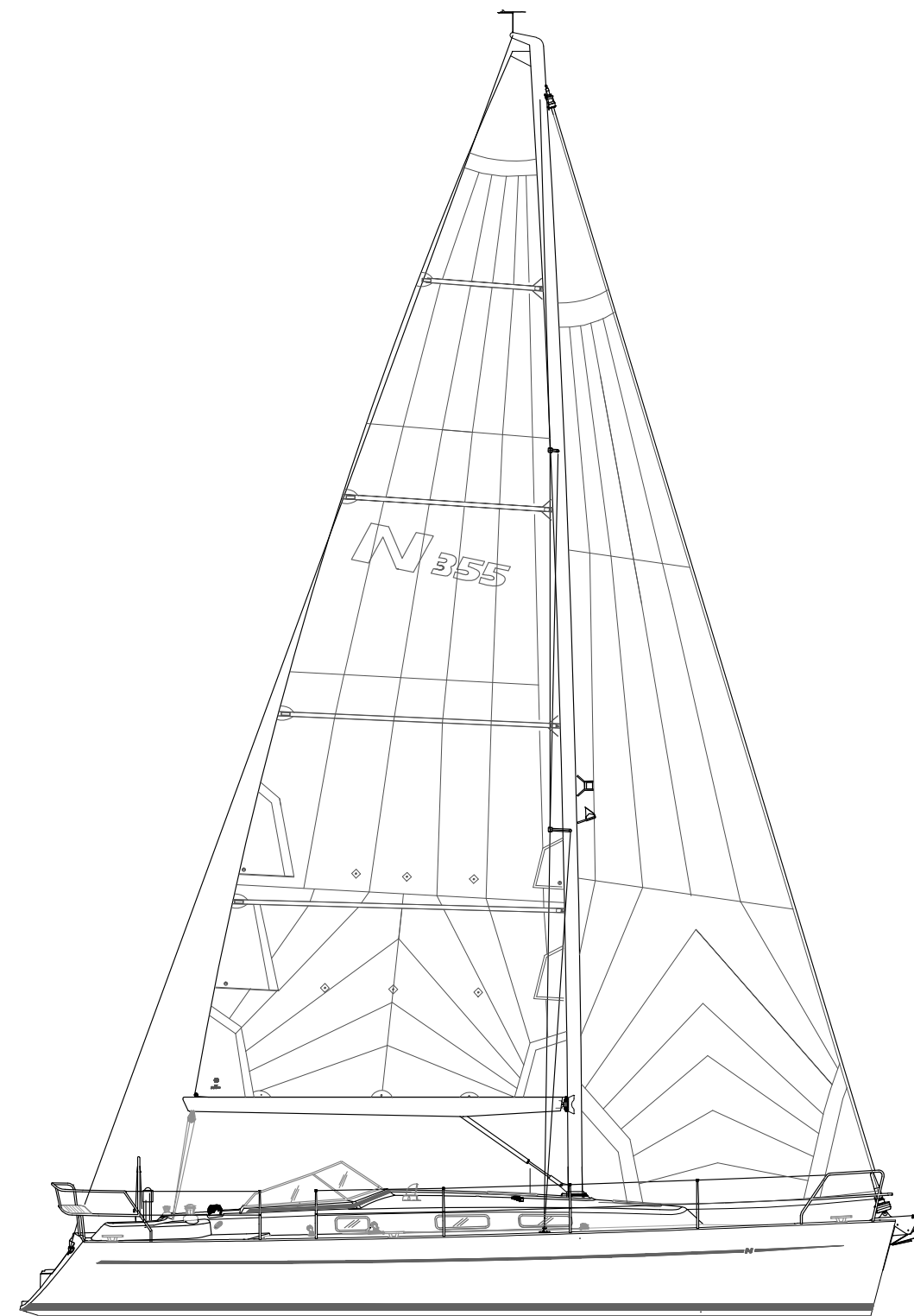

Sails:

Cruising	63.8 m ²
Full batten main	36.7 m ²
Working jib	27.1 m ²
* Furling Genoa	36.6 m ²
* Spinnaker	97 m ²
* Gennaker	91.7 m ²
* Self tacking jib	24 m ²

* Option



Engine

The Najad 355 is powered by the Volvo Penta D1-30S (option: D2-40S), a compact four-cylinder marine diesel producing 28,4 hp, with an S-drive and a 2-blade folding propeller. The engine is designed to work at low revs, putting the emphasis on low noise level and minimum vibration. High torque across the entire rev band and low emissions are other important characteristics.

Technical specifications D1-30S

- Crankshaft output 20,9 kW at 3000 r/min
- Configuration In-line 3-cylinder
- Generator 115 A
- Displacement 1,13 litres
- Weight incl. S-drive 158 kg
- Emissions BSO, SAV, RCD, EPA2
- Propeller S-drive, 2-blade folding propeller

Technical specifications D2-40S (option)

- Crankshaft output 29,1 kW at 3000 r/min
- Configuration In-line 4-cylinder
- Generator 115 A
- Displacement 1,51 litres
- Weight incl. S-drive 189 kg
- Emissions BSO, SAV, RCD, EPA2
- Propeller S-drive, 2-blade folding propeller



Batteries

Battery chargers, inverters and batteries are available in a number of different varieties for different needs.

AGM Batteries

With AGM technology you get deep cycling and high Amp capacity, ideal for feeding the inverter and DC consumers such as the navigation equipment and refrigerator. AGM as stands for Absorbed Glass Mat.

Mass Combi

The Mastervolt Mass Combi includes a three-stage charger and an inverter with sinus wave. The inverter can handle a peak power of 200 % and the charger keeps your batteries in shape for a long time.

Mass battery chargers

All Mastervolt chargers take care of all types of batteries and keep them fully charged without overcharging.

Mass inverters

Mastervolt Mass inverters deliver pure sinus wave to the onboard equipment.



Electrical system

Domestic system voltage is 12V. Electric power is generated by a 115 A alternator linked to the main engine, or via the shore power connected battery charger that is standard.

Standard AGM batteries with a total domestic capacity of 240 Ah, and a separate AGM start battery with a capacity of 75 Ah. All the fuses in the panel are of the semi-automatic circuit breaker type.

The tank monitors are programmed to the shape of each tank and display readings digitally in either liters/gallons or percent.

The scope of the electrical system varies with the equipment specified on board.

Standard electrical equipment

- ST 60 Plus Speed-Depth-Wind
- Dimmer in saloon
- Code locked 12 volt domestic system
- AGM Batteries 240 Ah
- Digital water and fuel tank meters showing contents in litres/gallons
- Water heater

Standard mechanical equipment

- Volvo S-drive 28,4 hp
- Volvo 2-blade folding propeller
- Holding tank with warning indicator (75% full)
- Electric emergency bilge pump
- Manually operated bilge pump



Space for the good life. Modern, timeless elegance inside that draws its inspiration from exclusive one-off yachts.



The N355 has excellent sailing characteristics. So generally, people are surprised when discovering spacious cabins, galley and head with separate shower below deck. Lots of stowage and standing head-room in nearly all areas.



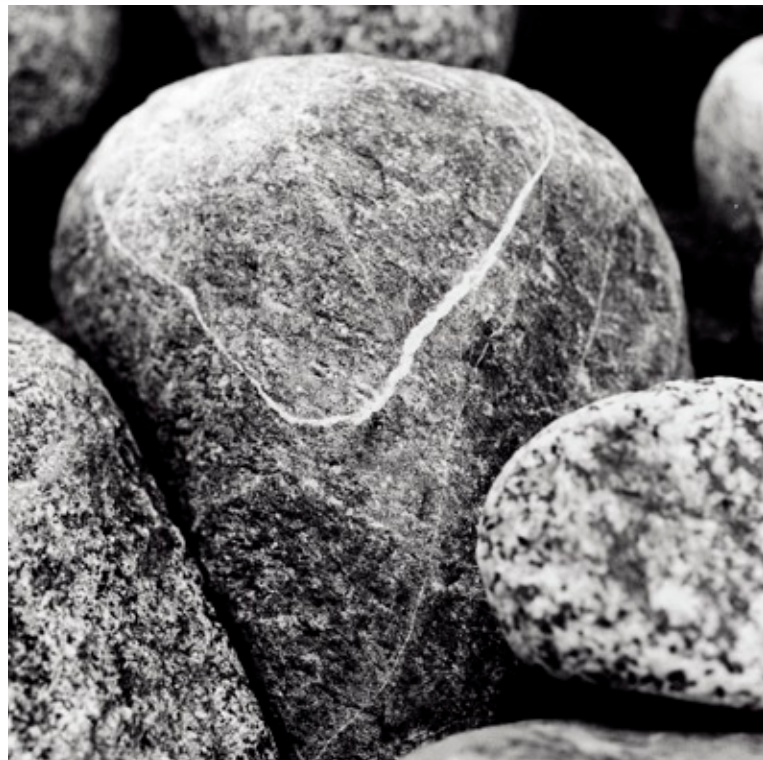

The unique Najad windscreen design gives you shelter enabling you to arrive well rested.



The N355 - Challenge yourself in comfort.



State of the art design by Rhoades Young and superb interior finish by Najad Yachts.



No matter the challenge, the displacement and hull design ensures a safe voyage in comfort.



For nine hundred years the people of Orust, Bohuslän have been sailors and shipbuilders. A heritage today carried on by the skilled boat builders at Najad.



Below deck is light and surprisingly spacious with standing headroom in nearly all areas.



The construction - hull and deck together with stingers and bulkheads - creates a very strong unit. In other words, you can go anywhere in the world in a standard Najad.





NAJAD

YACHTS *of* SWEDEN

Najadvarvet

Box 10, 473 21 Henan, Sweden

Tel: +46 304 692 300 Fax: +46 304 692 301 info@najad.se

Najad Yachts UK

Hamble Point Marina, School Lane, Hamble,
Southampton, SO31 4NB, UK

Tel: +44 2380 455 555 Fax: +44 2380 455 450
najadsales@btclick.com

www.najad.com



The brochure is for promotional purposes only and cannot form part of any contract or offer. Najadvarvet AB will not be held responsible for the consequences of any errors or omissions. Pictures and illustrations are made to show non-standard equipment.

